

# USB Cable Retainer Instructions

## Included Parts

USB Cable Retainer  
(x2)

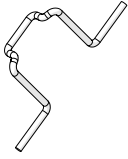

QMN-04-15176

Retainer Screws  
M3 x 10 mm (x4)

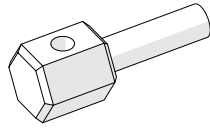

QMN-08-15177

Male to Male  
USB Adapter

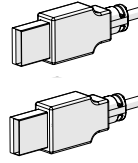

QMN-02-12763

Q'nique to  
QuiltMotion USB

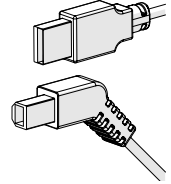

QMN-02-12764

## Tools Needed (Not Included)

T-handle Allen  
Wrench 2 mm

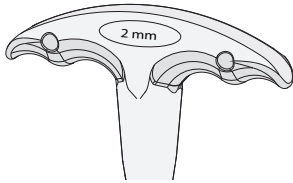

Small Adjustable  
Crescent Wrench

## Instructions

Take the following steps to attach the USB cable retainers to your machine. These steps apply to both the Q'nique 15 series and Q'nique 21 series machines.

- 1 Locate the two USB ports on the top and the rear of the machine

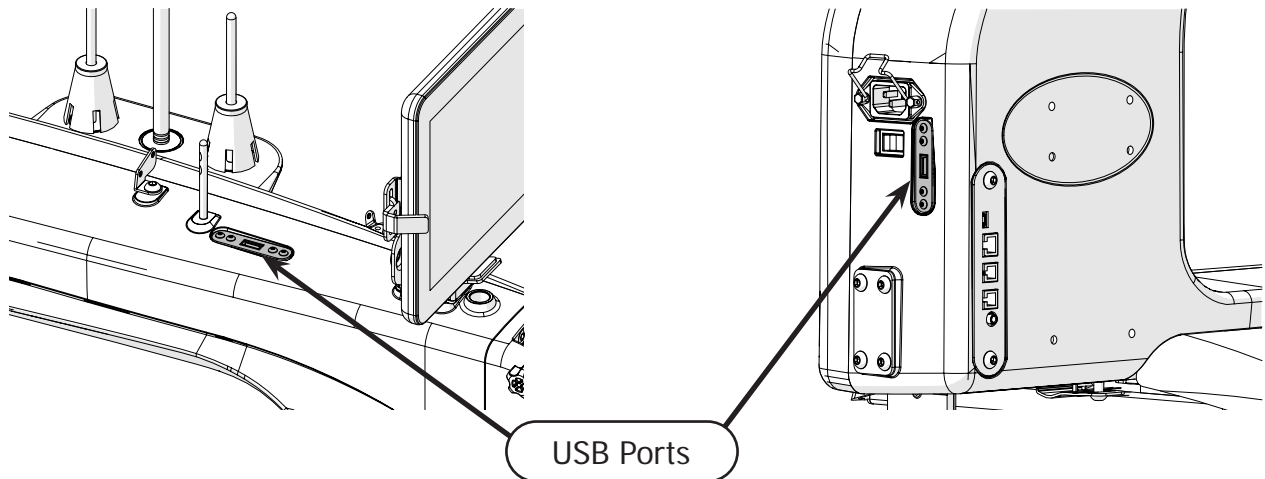

- 2 Use the 2 mm Allen wrench to remove **one** of the **outside screws** for the top USB port.

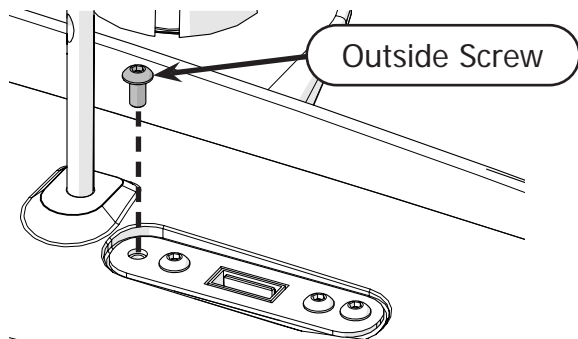

**Note:** DO NOT remove the inside screws.

- 3 Replace the screw you just removed with one of the **retainer screws**. Tighten with the crescent wrench so that the **retainer hole** in the top of the screw faces the USB port.

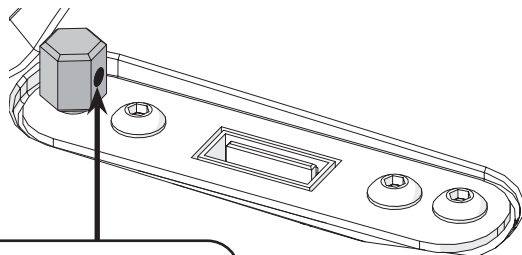

- 4 Repeat steps 2-3 for the other outside screw.

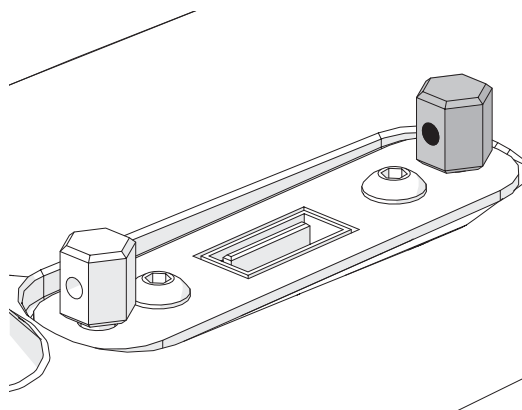

- 5 Pinch the sides of the **USB cable retainer** and insert the ends into the holes in the retainer screws.

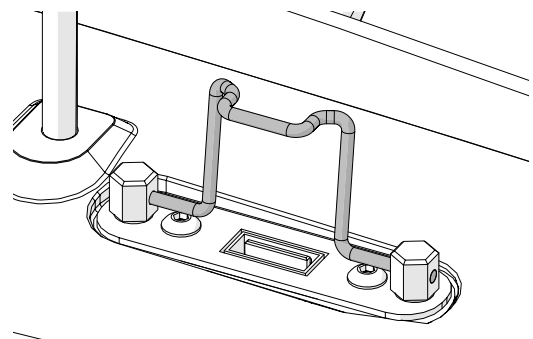
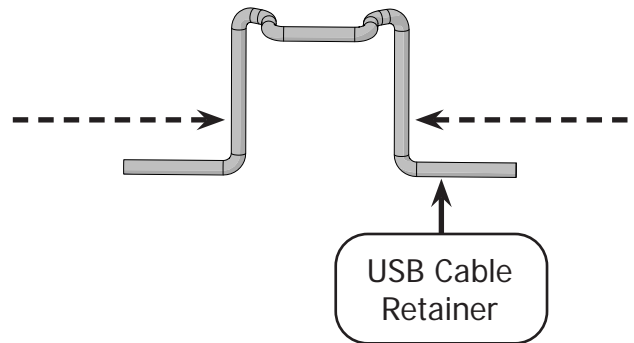

**Note:** The retainer may slide side to side once in the holes, and you may need to re-insert one of the ends into the screw. It will stay in place once the USB is plugged in.

- 6 Plug the Male to Male USB cable into the port and lift the retainer to wrap around the cable and hold it in place. Plug the other end into your tablet.

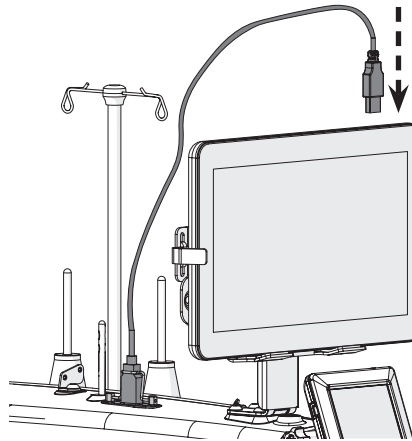
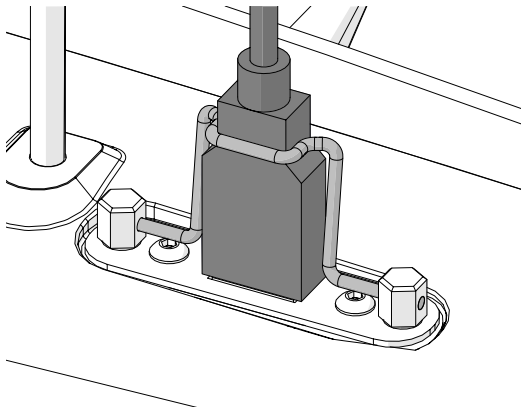

**Note:** Location of USB port on tablet may vary.

- 7 Repeat steps 2-5 for the rear USB port.

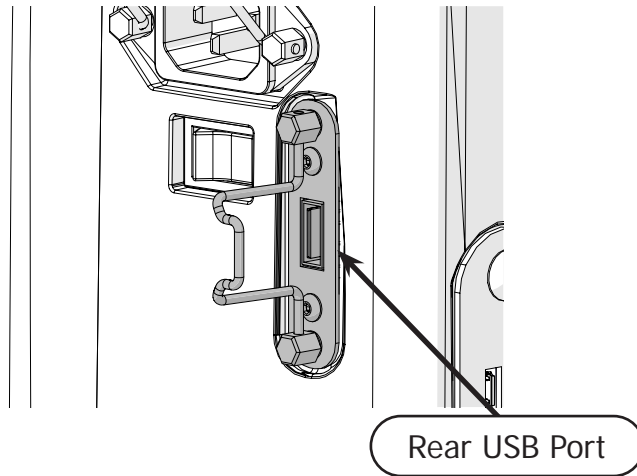

- 8 Plug the USB end of the Q'nique to QuiltMotion cable into the rear USB port and lift the retainer to wrap around the cable and hold it in place. Plug the other end of the cable into the left port of the motor plate.

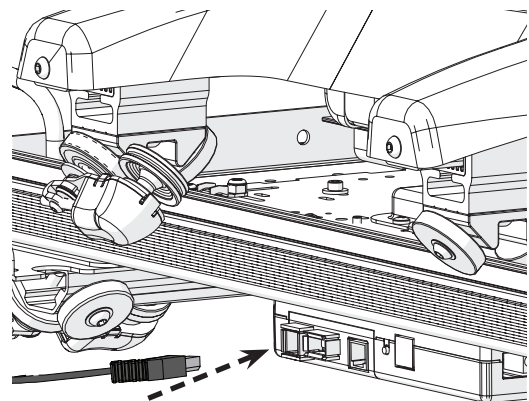
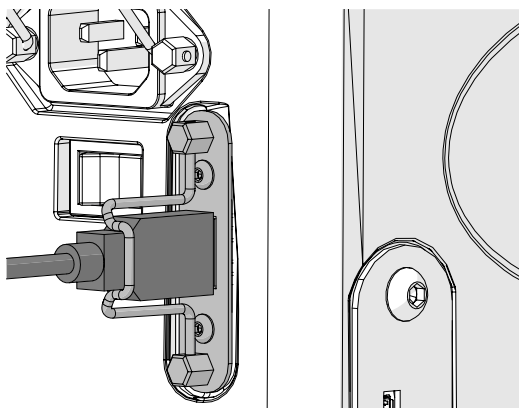

**The Grace Company**  
**Phone: 1-800-264-0644**  
**[www.graceframe.com](http://www.graceframe.com)**

